

AS 1200AS

SS (Type 304),  ZTC,  Other \_\_\_\_\_

**O.D. TUBING CLAMP**

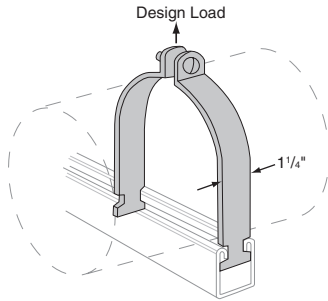

**Now only offered in Pre-Assembled**

Size	Tube Size	Load Rating	Std Pkg	Wt/100 pcs
1/4"	1/8"	400	100	8
3/8"	1/4"	400	100	8
1/2"	3/8"	400	100	9
5/8"	1/2"	400	100	10
3/4"	5/8"	400	100	11
7/8"	3/4"	400	100	12
1"	7/8"	600	100	14
1 1/8"	1"	600	100	15
1 1/4"	1 1/8"	600	100	16
1 3/8"	1 1/4"	600	100	17
1 1/2"	1 3/8"	600	100	18
1 5/8"	1 1/2"	600	100	19
1 3/4"	1 5/8"	800	50	29
1 7/8"	1 3/4"	800	50	28
2"	1 7/8"	800	50	31
2 1/8"	2"	800	50	32
2 1/4"	2 1/8"	800	50	33
2 3/8"	2 1/4"	800	50	34
2 1/2"	2 3/8"	800	50	35
2 5/8"	2 1/2"	800	50	37
2 3/4"	2 5/8"	800	50	38
2 7/8"	2 3/4"	800	50	40
3"	2 7/8"	800	50	41
3 1/8"	3"	800	50	43
3 1/4"	3 1/8"	800	50	45
3 3/8"	3 1/4"	800	50	46
3 1/2"	3 3/8"	800	50	47
3 5/8"	3 1/2"	800	50	56
3 3/4"	3 5/8"	800	25	58
3 7/8"	3 3/4"	1000	25	60
4"	3 7/8"	1000	25	62
4 1/8"	4"	1000	25	62
4 1/4"	4 1/8"	1000	25	64
4 3/8"	4 1/4"	1000	25	66
4 1/2"	4 3/8"	1000	25	67

Std Pkg & Wt/100 pcs: See chart above.

AS 2651

ZTC  Other \_\_\_\_\_

**BEAM CLAMP**

T1 Use With AS 200, AS 210, AS 300, AS 400, AS 500, AS 520. T2 Use With AS 100, AS 150, and AS 200BTB.

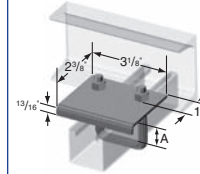

No.	A	Load Rating
T1	3 3/8"	1000
T2	5"	1000

Std Pkg: 25 · Wt/100 pcs: 80 lbs.

AS 3033

ZTC  Other \_\_\_\_\_

**POST BASE**

Use With AS 200 and AS 210.

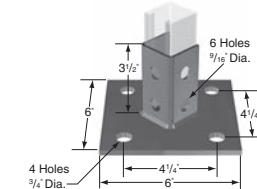

Std Pkg: 10 · Wt/100 pcs: 373 lbs.

AS 3064

ZTC  Other \_\_\_\_\_

**DOUBLE COLUMN POST BASE**

Use With All 3 1/4" Channels.

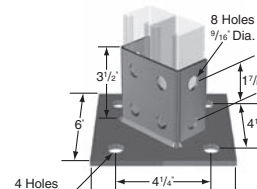

Std Pkg: 10 · Wt/100 pcs: 408 lbs.

**LEGEND:**

GR: Powder Coated Supr-Green PG: Pre-Galvanized AL: Aluminum HG: Hot Dipped Galvanized PL: Plain SS: Stainless Steel ZTC: Zinc Trivalent Chromium

**PROJECT INFORMATION**

**APPROVAL STAMP**

<b>Project:</b>	<input type="checkbox"/> Approved
<b>Address:</b>	<input type="checkbox"/> Approved as noted
<b>Contractor:</b>	<input type="checkbox"/> Not approved
<b>Engineer:</b>	<b>Remarks:</b>
<b>Submittal Date:</b>	
<b>Notes 1:</b>	
<b>Notes 2:</b>	